

LOCATION

Shangri-La’s Sanya Resort and Spa, Hainan is situated along the striking Haitang Bay of Sanya on the southern part of Hainan island. The secluded resort features 300 metres of immaculate beachfront and is surrounded by mountains. It is an ideal choice for both leisure and business travellers. The resort is just 40-minute drive from both downtown and Sanya Phoenix International Airport.



ACCOMMODATION

The resort comprises 496 modern guestrooms and spacious suites, including eight private double-story villas of contemporary and indigenous design. All rooms feature private balconies with memorable views of the mountains, or of the South China Sea. Villas are provided with butler services and feature luxurious space with a private pool embraced by a beautiful garden, which offers a relaxed luxury lifestyle for high-end travelers. Horizon Club Rooms and Suites as well as the eight 2-bedroom villas provide exclusive Horizon Club Lounge benefits.

ROOM INVENTORY

Categories	Rooms	Area (m²)
Deluxe King Room	100	54-64
Deluxe Twin Room	83	54-64
Deluxe Sea View King Room	78	54-64
Deluxe Sea View Twin Room	29	54-64
Premier Sea View King Room	84	54-64
Premier Sea View Twin Room	28	54-64
Horizon Club King Room	22	64-77
Horizon Club Twin Room	24	64
Horizon Sea View King Room	29	64-77
Ocean Suite	5	112
Horizon Suite	6	136
Ocean Pool Villa	4	302
Pool Villa	4	302
Total Room Inventory	496	

GUESTROOM FEATURES

- All guestrooms are fully-equipped with modern amenities including:
- In-room Wi-Fi access
 - LCD TV
 - Satellite / cable television with extensive news and movie channels
 - IDD telephone with bathroom extension
 - Iron and ironing board
 - Mini-bar
 - Voice mail
 - Electronic safe
 - Coffee and tea-making facilities
 - 24-hour in-room dining

HORIZON CLUB BENEFITS

- Check-in/-out service at the Horizon Club Lounge, with the option of a late check-out
- A full range of secretarial services at the Horizon Club Lounge
- Access to Horizon Club Lounge
- Breakfast in Horizon Club Lounge
- Evening cocktails and canapés
- Beverages served all day
- Wi-Fi and broadband Internet access
- A wide selection of newspaper and magazines
- Pressing of two pieces of clothing upon arrival
- Use of the meeting room for up to 2 hours per day

BANQUET AND CONFERENCE ROOMS

Venue	Capacity				Dimensions (m)	Area (m ²)	Ceiling Height (m)
	Reception	Theatre	Banquet	Classroom			
Level 1							
Qingshui	45	50	40	40	9.0 x 7.0	63	4
Guanri	45	50	40	40	9.0 x 7.0	63	4
Houhai	60	94	50	50	10.0 x 8.0	80	4
Haishan	60	94	50	50	10.0 x 8.0	80	4
Xidao	45	50	40	40	9.0 x 7.0	63	4
Yalong	50	60	50	48	9.0 x 8.0	72	4
Haiyue	45	50	40	40	9.0 x 7.0	63	4
Luhui	50	60	50	48	9.0 x 8.0	72	4
Foyer	•	•	•	•	•	400	4
Level 3							
Grand Ballroom	1,200	1,600	800	810	55.5 x 27.0	1,500	10
Tianya	350	500	260	270	18.5 x 27.0	500	10
Haijiao	350	500	260	270	18.5 x 27.0	500	10
Nantian	350	500	260	270	18.5 x 27.0	500	10
Grand Ballroom Foyer	510	•	•	•	60.0 x 8.5	510	8
Hongshu	•	•	•	•	8.0 x 8.0	64	3
Haitang	60	94	50	60	9.0 x 9.0	81	3
Fenghuang	60	94	50	60	9.0 x 9.0	81	3

LEVEL 1

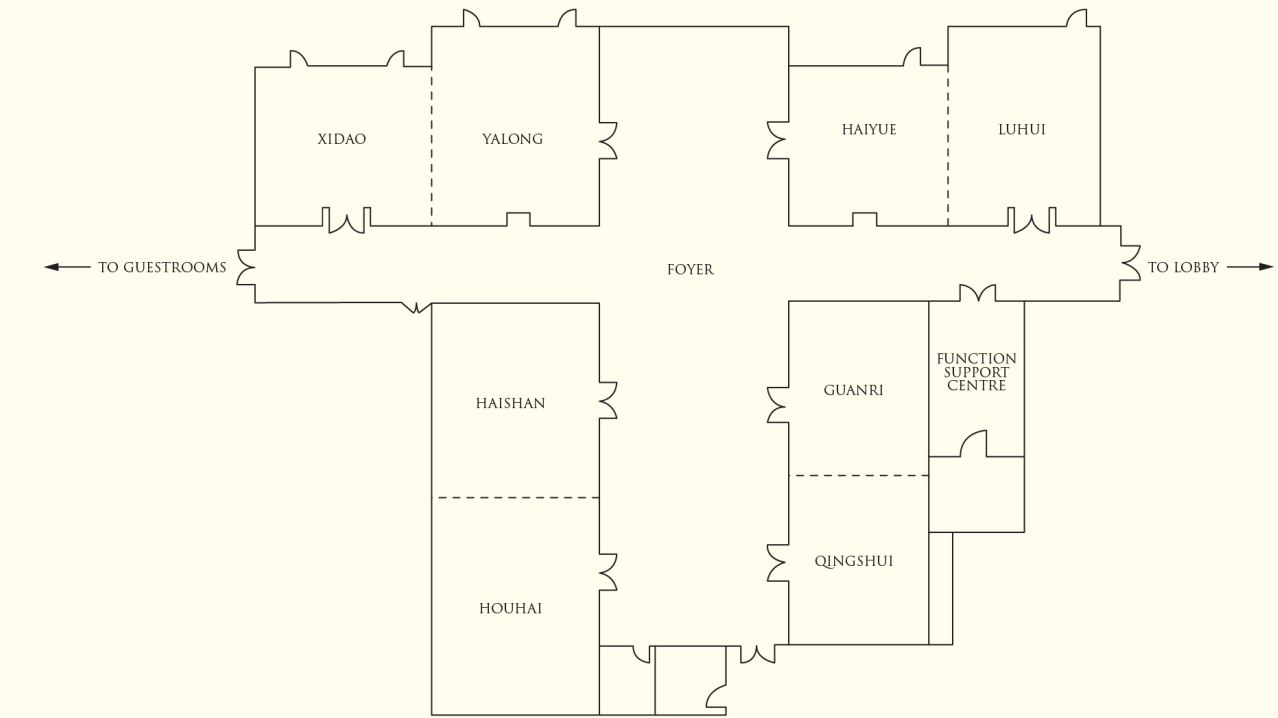

LEVEL 3

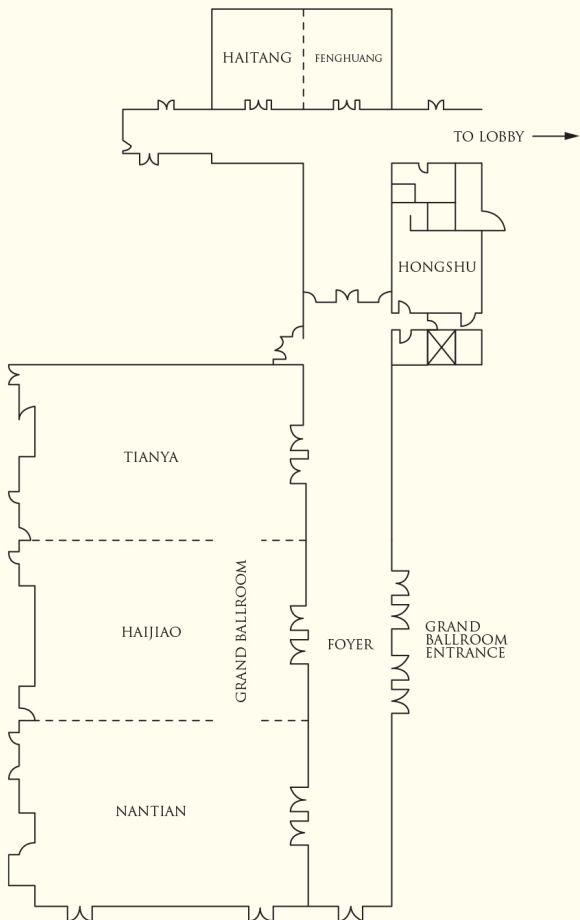

RECREATION FACILITIES

- Adventure Zone is a 510 square-metre indoor, air-conditioned playground specially designed for children aged five years and above. The multi-storey playground lets children swing on ropes, climb up and down nets and ladders or crawl through shapes made of safely padded vinyl. Daily activities are available for children. Long-sleeved shirts, long pants and socks are required for safety.
- The Toddler Zone is a play area for children aged four years and below. A parent or guardian must accompany children at all times.
- 360 square-metre outdoor kid’s water park
- 2,000 square-metre outdoor swimming pool
- Fully-equipped health club
- 300-metre sandy beach front
- Private Jogging Path, Forest Trail, and Lawn Trail
- The Funventure Boot Camp - The Archery Range, the Forest Park and the Shang Garden offer a wonderland for guests to explore.
- Resort Centre which helps to plan your vacation.

CHI, THE SPA AT SHANGRI-LA

CHI, The Spa transports guests into a world of quiet reflection. The Spa sprawls over 757 square metres and connects to a fabulous outdoor garden. Many of the spa massages and treatments are based on traditional healing methods found in China. Chi, The Spa is equipped with sauna, steam bath and 12 massage rooms.

FUNCTION SUPPORT CENTRE

The fully-equipped support centre offers a wide range of secretarial support including courier, facsimile, photocopying and printing services. Private meeting rooms are also available with a host of modern audiovisual, video conference and projection facilities plus broadband Internet access and Wi-Fi connection.

OTHER SERVICES AND FACILITIES

- Wired and wireless high-speed Internet access
- Laundry service
- Courier, parcel and postal services
- Limousine service
- Facilities for the physically challenged
- Outdoor and underground car park
- 24-hour assistant manager / concierge
- Store and gift shop
- Wheelchair-accessible rooms
- Non-smoking rooms
- Currency exchange
- Safety deposit boxes
- Resort Centre service

RESTAURANTS AND BARS

Resturants / Bars	Capacity	Location	Cuisine
Lobby Lounge	65	8F of Palm Wing	Beverage, snacks and light meals
Chuyi Wutai	366	1F of Palm Wing	International and Chinese
S.E.A.	138	1F of Ocean Wing	Southeast Asian and seafood
Dragonfly	75	Top floor of the Rock	Tropical Tiki Beverages
Kon Tiki	130	Ground floor of the Rock	Polynesian and island fair
Pool Bar	60	Beside outdoor pool	Beverage, snacks and light meals



Shangri-La’s Sanya Resort & Spa, Hainan
No.88 North Hai Tang Road, Sanya, Hainan 572000, China

电话：(86 898) 8875 8888 传真：(86 898) 8885 8899 sanya@shangri-la.com http://www.shangri-la.com/cn/sanya/shangrilasanya/



FACTS AND INFORMATION

SHANGRI-LA’S SANYA RESORT & SPA, HAINAN