



SHANGRI-LA  
KUALA LUMPUR



## Meetings & Conferences Packages 2024

### Full Day Package

9am - 5pm

#### PACKAGE A | RM320.00 ++ per person

- Use of main meeting room from 9am to 5pm
- Morning AND Afternoon coffee breaks daily with 3 types of snacks
- Conference Lunch
- Free flow of coffee/tea & water throughout the meeting
- Complimentary use of one flipchart
- Complimentary use LCD projector and Screen in meeting room
- Meeting stationery and mints throughout the meeting
- Hotel WIFI Internet Access
- \* *Additional RM50.00++ per person to have lunch in Lemon Garden (subject to availability)*

### Half Day Package

9am - 1pm | 2pm - 5pm

#### PACKAGE B | RM300.00 ++ per person

- Use of main meeting room from 9am-1pm or 2pm-5pm
- Morning OR Afternoon coffee/tea breaks daily with 3 types of snacks
- Conference Lunch
- Free flow of coffee/tea & water throughout the meeting
- Complimentary use of one flipchart
- Complimentary use LCD projector & Screen in meeting room
- Meeting stationery and mints throughout the meeting
- Hotel WIFI Internet Access
- \* *Additional RM50.00++ per person to have lunch in Lemon Garden (subject to availability)*

#### PACKAGE C | RM260.00 ++ per person

- Use of main meeting room from 9am-1pm or 2pm-5pm
- Morning OR Afternoon coffee/tea breaks daily with 3 types of snacks (Individual Serving)
- Free flow of coffee/tea & water throughout the meeting
- Complimentary use of one flipchart
- Complimentary use LCD projector & Screen in meeting room
- Meeting stationery and mints throughout the meeting
- Hotel WIFI Internet Access

Contact us with your event requirements and leave the planning to us!

[events.kualalumpur@shangri-la.com](mailto:events.kualalumpur@shangri-la.com) | +603 2032 2388

*All rates quoted are subject to 10% service charge and 8% government tax (SST).*

### YOUR WELL-BEING IN OUR CARE

The well-being and safety of our guests and colleagues remains our top priority which is why we are putting additional tried-and-tested safeguards to elevate our already rigorous hygiene and safety standards. We are supported by our long-time partner, Diversey – a leading global hygiene solutions provider who has a century of experience and expertise in this field.

We look forward to welcoming you back.



SAFE IN  
YOUR HANDS



COVER UP



KEEPING A  
SAFE DISTANCE



Learn more about the safety and cleanliness initiatives we have in place  
[www.shangri-la.com/cares/](http://www.shangri-la.com/cares/)

#ShangriLaCares



# MEETING UPGRADES LIVE STATION

- RM35.00++ per person per item to add on into coffee break session.
- Minimum 50 persons

## MALAYSIAN:

- Freshly Wrapped Nyonya Popiah
- Ipoh Chicken Hor Fun
- Curry Laksa
- Penang Assam Laksa
- Nasi Lemak Bungkus
- Hainanese Kaya Toast and Half-Boiled Eggs
- Deep Fried Banana Fitter
- Fresh Fruits Rojak

## ASIAN:

- Crab Meat Pai Tee
- Pulled Beef in Sesame Bun
- Xian Bread Pocket Stuffed with Braised Lamb
- Pan-Fried Shanghainese Sesame Pao
- California Hand Roll
- China Town Roasted Duck and Chicken
- Thai Mango Sticky Rice





# MEETING UPGRADES LIVE STATION

- RM35.00++ per person per item to add on into coffee break session.
- Minimum 50 persons

## WESTERN:

- Make Your Own Sandwiches
- Build Your Own New York Salmon Bagel
- Mini Burger with Condiments
- Long Sausage with Soft Bun and Condiments
- Egg Crepe Wrapped with Smoked Duck
- Egg Station:  
Scrambled Eggs / Omelette / Hard & Soft Boiled





## MEETING UPGRADES LIVE STATION

- RM35.00++ per person per item to add on into coffee break session.
- Minimum 50 persons

### BEVERAGE:

- Teh Tarik
- Freshly Squeezed Fruits,
- Vegetables and Smoothies
- Bubble Milk Tea
- Ice Blended Coffee
- Tea, Cocoa and Mocha



# BANQUET AND CONFERENCE ROOMS

Venue	Capacity					Dimensions (m)	Area (m <sup>2</sup> )	Ceiling Height (m)
	Reception	Theatre	Banquet	Classroom	Boardroom			
<b>BASEMENT II</b>								
Grand Ballroom (Sabah + Sarawak)	1,800	1,800	1,440	660	-	34.7x43.5	1,509	6.7
Sabah	700	1,100	600	420	-	34.7x26.1	905	6.7
Sarawak	450	650	400	378	84	34.7x17.4	604	6.7
Junior Ballroom (Selangor Room + Melaka)	400	300	400	200	-	43x17.3	744	4
Selangor Room (Kedah + Selangor 1 + Perak)	360	270	340	160	-	26x17.3	449	4
Kedah	120	140	100	87	42	8.7x17.3	150	4
Selangor 1	120	140	100	87	42	8.7x17.3	150	4
Perak	120	140	100	87	42	8.7x17.3	150	4
Melaka	200	200	160	120	42	16.9x17.3	292	4
Perlis	25	30	27	18	18	8.7x5.2	45	4
Sabah Ante	-	60	40	36	18	9.6x8.3	80	3
Foyer	800	-	-	-	-	-	1,151	4
<b>LOWER LOBBY</b>								
Johor 1/2/3	45	60	40	33	18	8.7x7.1	61	3.7
Johor (Johor 1+2+3)	140	160	120	100	60	26x7.1	184	3.7
Grand Johor (Johor 1+2+3+4+5+6)	360	270	340	160	-	26x15.8	410	3.7
Johor 1+4 / 2+5 / 3+6	120	140	100	87	42	8.7x15.8	137	3.7
Kelantan	70	80	50	45	36	6.2x14.1	87	3.7
Penang	80	90	50	48	36	6.2x16.1	100	3.7
Foyer	400	-	-	-	-	-	620	3.7
<b>LEVEL 1</b>								
Mezzanine 1,2&3	-	-	-	-	14	8.8x3.6	32	3.0
Mezzanine 4	-	-	-	-	8	3.5x5.7	20	3.0

# BANQUET AND CONFERENCE ROOMS

## BASEMENT II

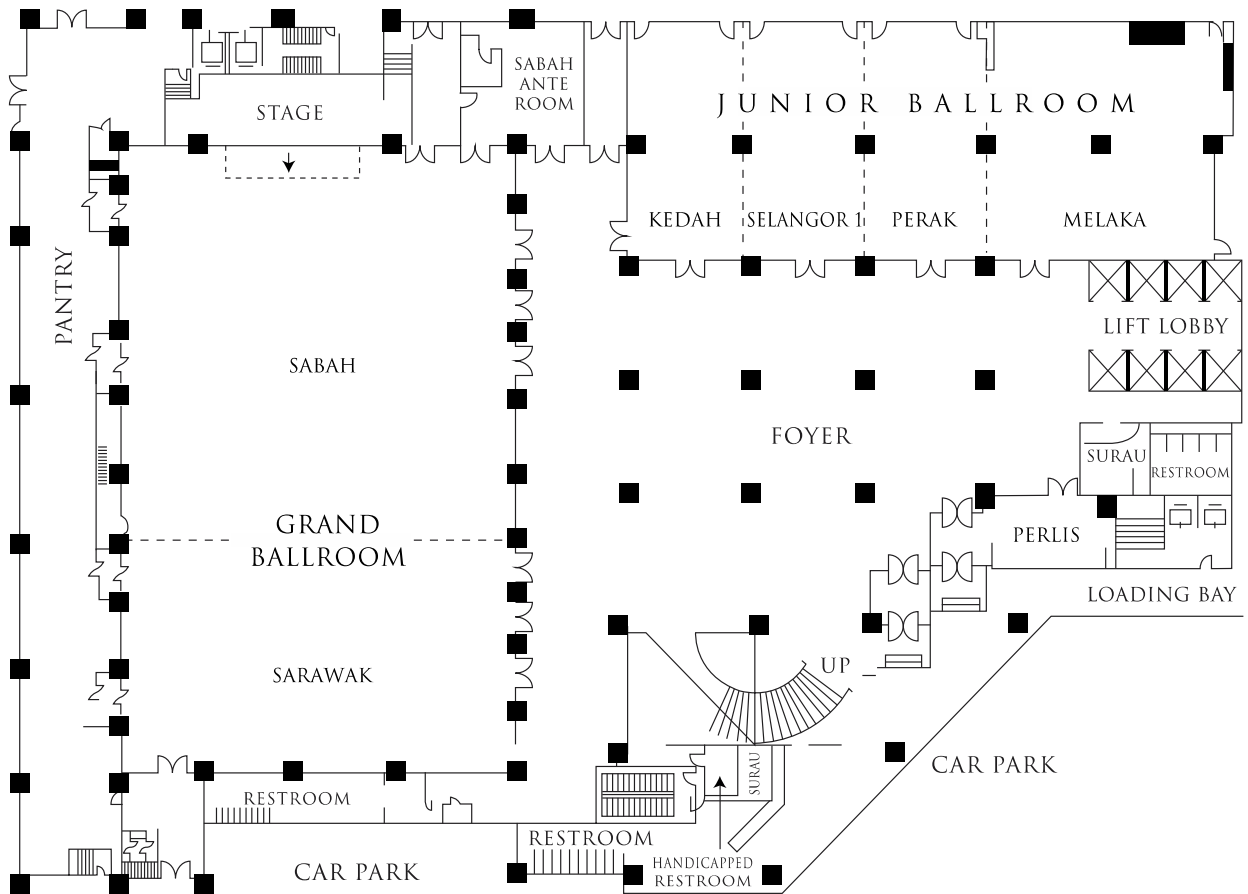

# BANQUET AND CONFERENCE ROOMS

LOWER LOBBY

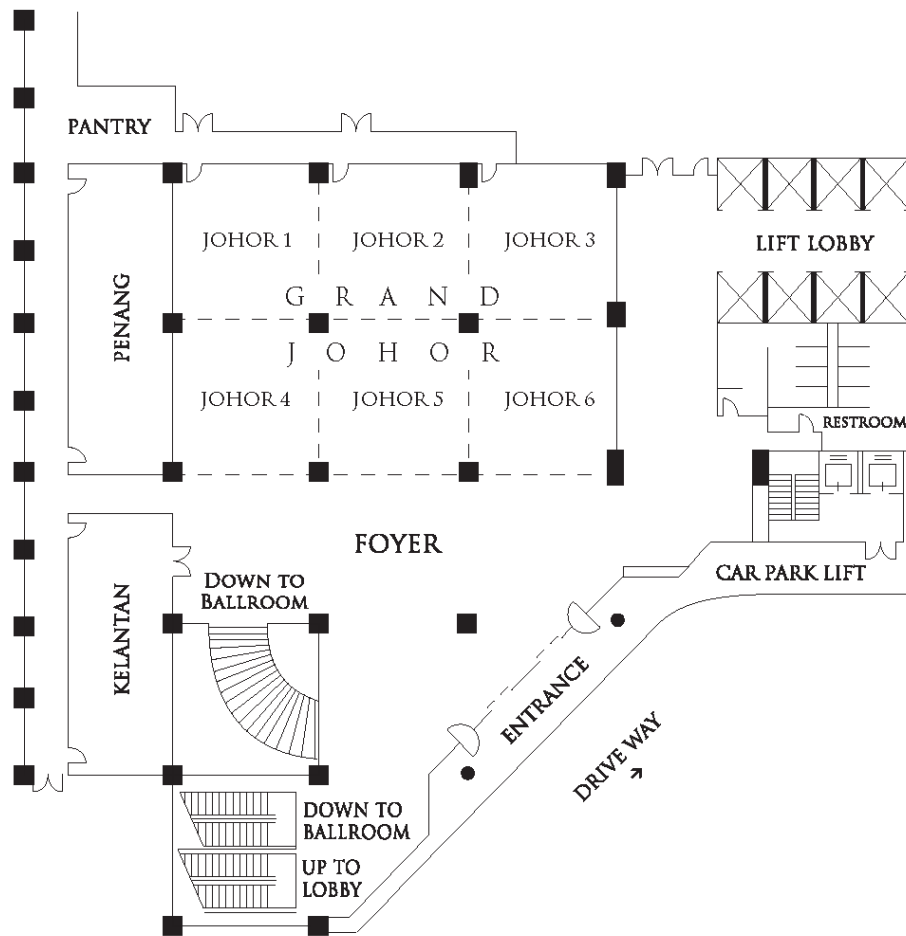

LEVEL I

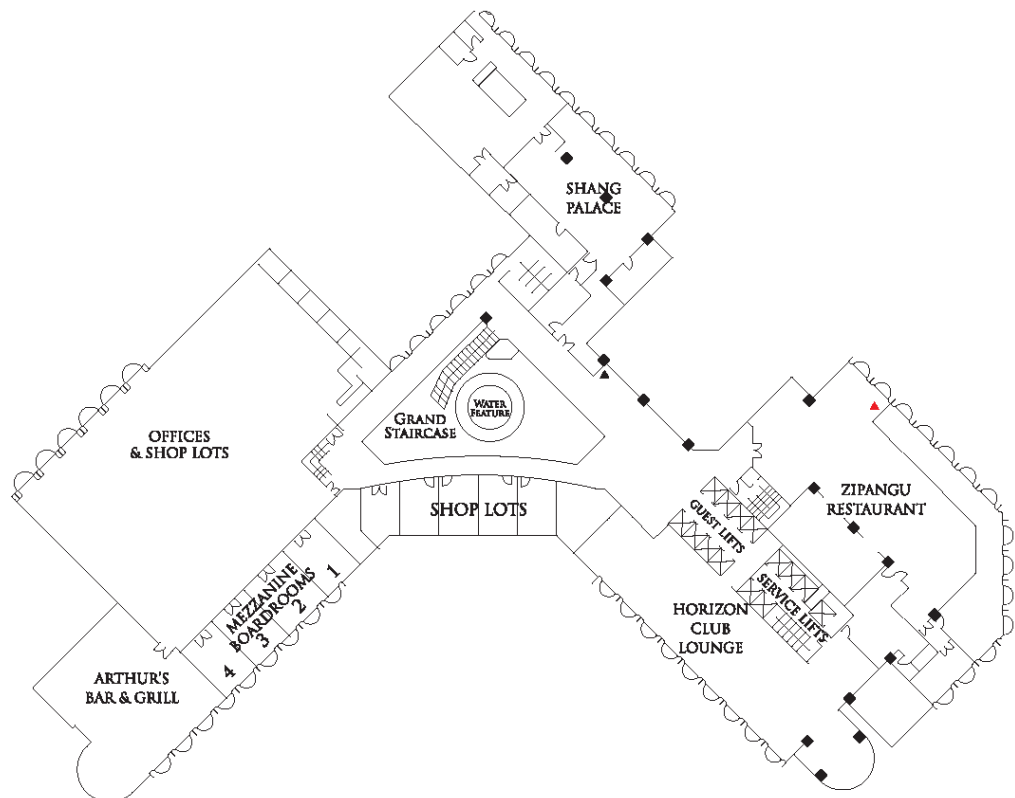



---

Contact us with your event requirements  
and leave the planning to us!  
[events.kualalumpur@shangri-la.com](mailto:events.kualalumpur@shangri-la.com)  
+603 2032 2388

  
**SHANGRI-LA**  
KUALA LUMPUR

11 Jalan Sultan Ismail, 50250 Kuala Lumpur, Malaysia. [www.shangri-la.com](http://www.shangri-la.com)