



## FACTS AND INFORMATION

SHANGRI-LA KUALA LUMPUR

## LOCATION

Nestled amidst lush greenery in the heart of the city, Shangri-La Kuala Lumpur is just moments from the city's leading business, shopping, entertainment districts and heritage and historical sites. The hotel is merely a five-minute walk to the iconic Petronas Twin Towers and Kuala Lumpur International Airport is only 45 minutes away by car.

## ACCOMMODATION

The hotel comprises 662 luxurious guestrooms, including 69 units elegant suites, all with panoramic views of the city or the tranquil gardens. For the more discerning traveller, the Horizon Club provides the highest level of personalised attention with four floors of executive accommodation and an exclusive private lounge.

## RECREATION FACILITIES

- Fully equipped health club
- Hot whirlpool baths, sauna and steam room
- Massage, reflexology and aromatherapy
- Yoga and stretching
- Outdoor swimming pool and children's pool

## HORIZON CLUB PRIVILEGES

- Personalised check-in and check-out service
- Complimentary breakfast, all-day refreshments, afternoon tea and evening cocktails in Horizon Club Lounge
- Concierge service
- One Complimentary suit pressing on arrival
- Daily international newspaper
- Private meeting room and computer stations
- Complimentary Wi-Fi broadband Internet access in guestrooms and Horizon Club Lounge
- Pillow menu
- Basic secretarial services

## GUESTROOM FEATURES

- Satellite / cable TV
- 24-hour in-room dining
- IDD telephones with data port and voice mail
- Full-size executive desk
- Complimentary Wi-Fi broadband Internet access
- Electronic safe
- Tea and coffee-making facilities
- Mini-bar
- Hairdryer
- Belikin BOOSTCHARGE PRO 4-Port fast Charger

## OTHER SERVICES AND FACILITIES

- Limousine and taxi services
- Laundry and valet services
- Safe deposit boxes
- Parking facilities
- Hair/ beauty salon
- Shopping arcade
- Foreign exchange counter
- Tour desk
- Shuttle bus service
- Les Clefs d'Or (Golden key services)
- WeChat Communication
- WeChat payment service
- AliPay payment service
- Guest Relations for Chinese-speaking guests
- Family and Children's activities with a Chinese-speaking Kid's Ambassador



## GUESTROOMS

Categories	Rooms	Area (m <sup>2</sup> )
Deluxe Room	96	37
Executive Room	358	39
Premier Business Room	10	39
Horizon Club Executive Room	97	39
Family Premier Suite	12	80
Premier Selection Suite	84	80
Specialty Suite	3	115
Malaysian Suite	1	240
Royal Suite	1	240

## PREMIER BUSINESS ROOM

The ultimate business experience mobile Plug & Play workstation and enhanced business-friendly amenities.

- Adjustable height mobile Plug & Play workstation with tabletop electrical sockets and Qi wireless charger
- 55-inch Samsung SMART TV
- Dell 27-inch 4K USB-C Hub Monitor
- Blue Yeti X Professional USB Microphone
- Creative Stage Air V2 Soundbar
- Logitech BRIO 4K Webcam
- Logitech Master MX 3S Wireless Mouse Graphite
- Logitech MX Mechanical Wireless Illuminated Keyboard
- Wi-Fi broadband Internet access

## MOBILE PLUG & PLAY UPGRADE

- Adjustable Height Mobile Plug & Play Workstation
- Dell 27-inch 4K USB-C Hub Monitor (Dual Screens or Single Screen available upon request)
- PolySync 4.0 Speakerphone or Blue Yeti microphone with speaker
- Logitech BRIO 4K Webcam
- Logitech Master MX 3S Wireless Mouse Graphite
- Logitech MX Mechanical Wireless Illuminated Keyboard

## RESTAURANTS AND BARS

Restaurants / Bars	Capacity	Location	Cuisine
Lobby Lounge	136	Lobby Level	Snacks and beverages
Lemon Garden	368	Lobby Level	Local and international
Lemon Garden 2Go	61	Lobby Level	Continental snacks
Shang Palace	192	Level 1	Cantonese
Zipangu	178	Level 1	Japanese
Arthur's Bar & Grill	163	Level 1	Local and international
Poolside Terrace	46	Level 2	Snacks and beverages

## BANQUET AND CONFERENCE ROOMS

Venue	Reception	Theatre	Round Table	Classroom	Boardroom	Dimensions (m)	Area (m <sup>2</sup> )	Ceiling Height (m)
<b>Basement II</b>								
Grand Ballroom (Sabah + Sarawak)	1,800	1,800	1,320	660	-	34.7x43.5	1,509	6.7
Sabah	700	1,100	720	420	-	34.7x26.1	905	6.7
Sarawak	450	650	600	378	84	34.7x17.4	604	6.7
Junior Ballroom (Selangor Room + Melaka)	550	600	560	200	-	43x17.3	744	4
Selangor Room (Kedah + Selangor 1 + Perak)	360	420	360	200	-	26x17.3	449	4
Kedah	120	140	120	87	42	8.7x17.3	150	4
Selangor 1	120	140	120	87	42	8.7x17.3	150	4
Perak	120	140	120	87	42	8.7x17.3	150	4
Melaka	200	200	216	120	42	16.9x17.3	292	4
Perlis	-	-	24	-	18	8.7x5.2	45	4
Negeri Sembilan	-	-	24	-	18	9.6x8.3	80	3
Foyer	800	-	-	-	-	-	1,151	4
<b>Lower Lobby</b>								
Junior Ballroom II (Johor + Pahang + Terengganu)	360	270	288	243	-	8.7x7.1	137	3.7
Johor	120	140	96	81	42	26x7.1	410	3.7
Pahang	120	140	96	81	42	26x7.1	410	3.7
Terengganu	120	140	96	81	42	26x7.1	410	3.7
Kelantan	70	80	48	45	24	-	87	3.7
Penang	80	90	48	48	24	-	100	3.7
Foyer	400	-	-	-	-	-	620	3.7
<b>Lobby</b>								
Garden Room	150	120	120	50	30	-	-	-
Shangri-La Garden	300	-	-	-	-	-	-	-
<b>Level 1</b>								
Mezzanine 1,2&3	-	-	-	-	14	-	32	3.0
Mezzanine 4	-	-	-	-	8	8.8x3.6	20	3.0

LOWER LOBBY

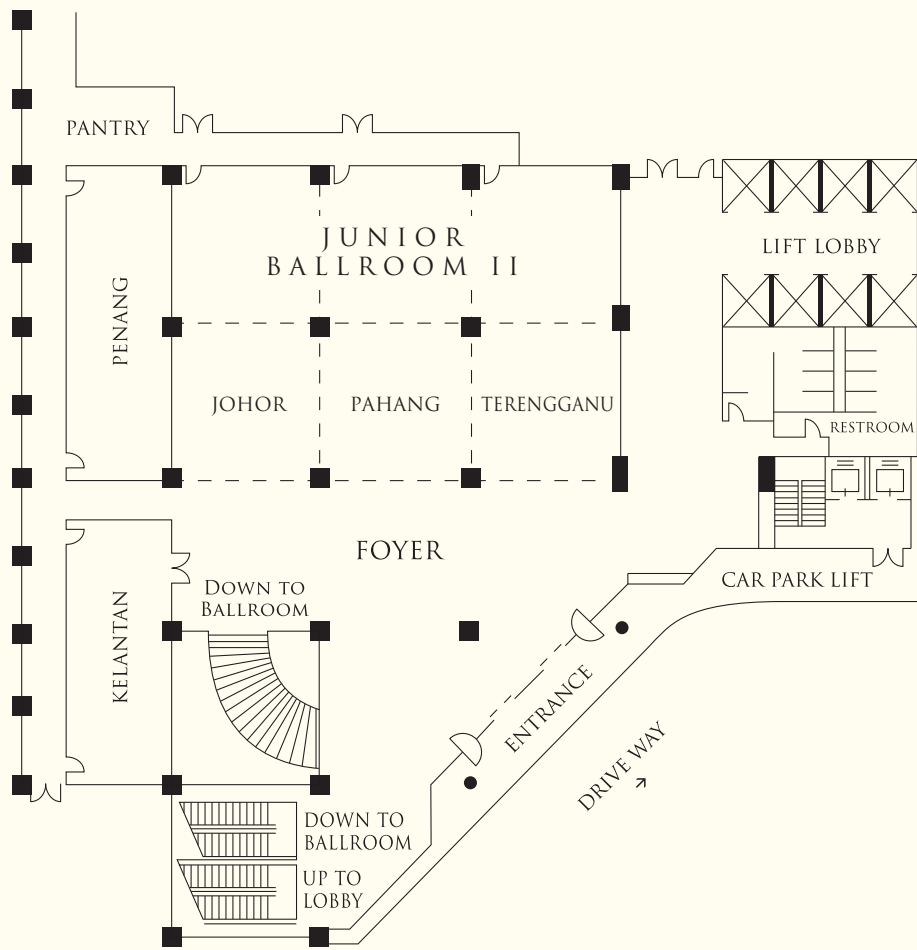

LEVEL I

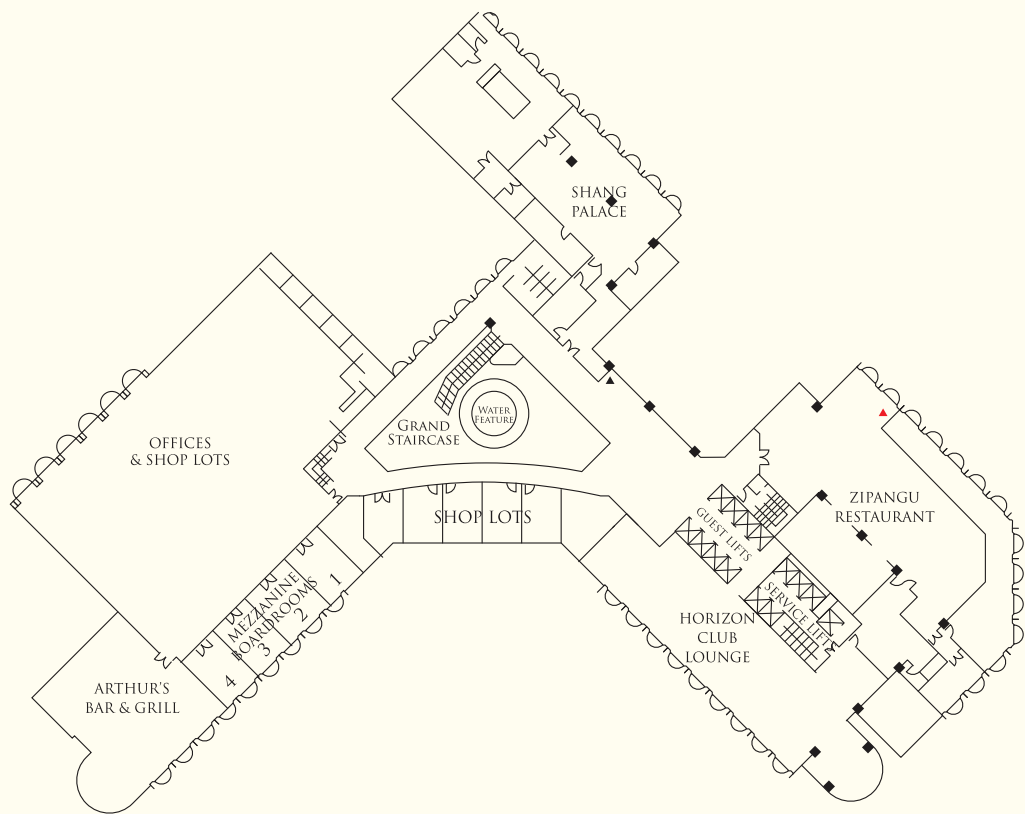

The floor plan of the 1st floor of the Universiti Kebangsaan Malaysia (UKM) Main Building is as follows:

- Top Left:** STAGE, NEGERI SEMBILAN
- Top Right:** JUNIOR BALLROOM, KEDAH, SELANGOR, PERAK, MELAKA
- Left Side:** PENTRY, SABAH
- Center:** GRAND BALLROOM, Foyer
- Right Side:** LIFT LOBBY, SURAU, RESTROOM, PERLIS, LOADING BAY
- Bottom Left:** SARAWAK, RESTROOM, CAR PARK
- Bottom Center:** RESTROOM, HANDICAPPED RESTROOM, CAR PARK
- Bottom Right:** CAR PARK
- Staircase:** UP

The floor plan of the 1st floor includes the following labeled areas:

- SHANGRI-LA GARDEN
- GARDEN ROOM
- LOBBY LOUNGE
- GRAND STAIRCASE
- WATER FEATURE
- GUEST LIFTS
- SERVICE LIFTS
- LEMON GARDEN





SHANGRI-LA

SHANGRI-LA HOTEL (KL) SENDIRIAN BERHAD  
Registration No.196901000758 (9159-V)

11, Jalan Sultan Ismail, 50250 Kuala Lumpur, Malaysia

Tel: (603) 2032 2388 Fax: (603) 2070 1514 [kualalumpur@shangri-la.com](mailto:kualalumpur@shangri-la.com) [www.shangri-la.com](http://www.shangri-la.com)

19Dec2025