

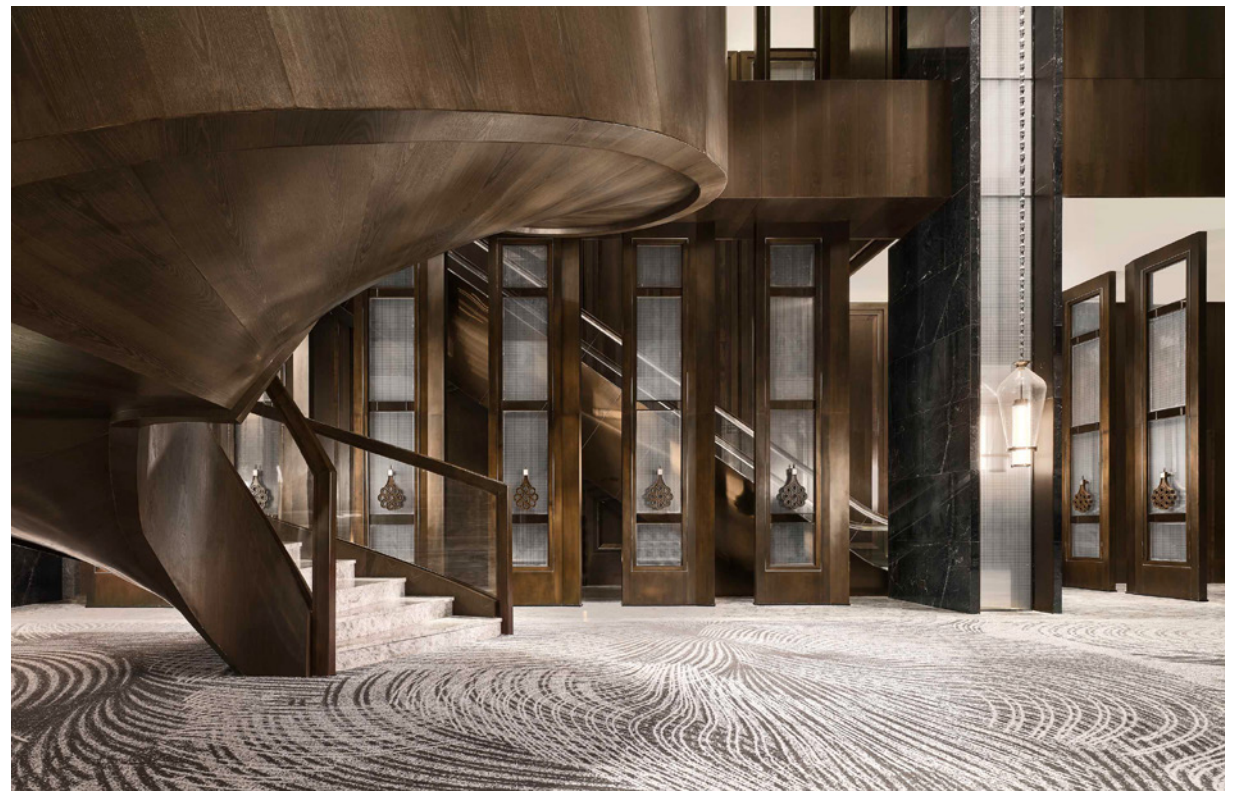

شانغريلا جدة  
SHANGRI-LA  
JEDDAH



## SHANGRI-LA, JEDDAH *Meeting Packages*

### Half day meeting packages

Inclusive of 1 coffee break and lunch

### Whole day meeting package

Inclusive of 2 coffee breaks and lunch

mentioned rates subject to 15% VAT

The meeting package includes the following (applicable for a minimum of 10 persons per function)

- Use of the meeting room from 9:00 - 17:00 (whole day)
- Use of the meeting room from 9:00 - 13:00 or 13:00 - 17:00 (half day)
- Two coffee breaks (whole day), or one coffee break (half day)
- Flowing coffee, tea and still water throughout the meeting
- Lunch at the waterfront Kitchen restaurant one round of drinks (choice of soft drinks or chilled juices)
- Use of 2 flipcharts with markers
- Meeting stationery and mints
- Use of 1 LCD screen and AV connections
- Professional technical assistance
- Complimentary use of WiFi

Address: Burj Assila, Corniche Road, Ash Shati, Jeddah 23611 Saudi Arabia  
Phone: (966) 12 696 8888 | E-mail: [jeddah@shangri-la.com](mailto:jeddah@shangri-la.com)