



## FACTS AND INFORMATION

SHANGRI-LA'S MACTAN RESORT & SPA  
CEBU

## LOCATION

Shangri-La's Mactan Resort and Spa, Cebu is set amidst 13 hectares of lush tropical greenery in Lapu-Lapu City, and connected to the main island of Cebu by several bridges. An ideal base for both leisure and business travellers, the resort is only a short 20-minute drive to the Mactan Cebu International Airport.

## ACCOMMODATION

The resort comprises 530 lavish guestrooms and suites characterised by contemporary décor with Filipino touches of banana leaf and rattan. Rooms feature memorable views of the Mactan Sea and the surrounding Shangri-La Marine Sanctuary and islets. Ocean Club Rooms, located in the exclusive Ocean Wing, offer an enhanced level of comfort, and provide private balconies facing the beautiful Mactan Channel.



## GUESTROOMS

Categories	Rooms	Area (m <sup>2</sup> )
<b>Main Wing</b>		
Deluxe	185	34 - 36
Deluxe Sea View	151	34 - 36
Deluxe Family Room	8	54 - 58
Mactan Suite	3	68
Veranda Suite	5	105
Shangri-La Suite	2	136
<b>Ocean Wing</b>		
Premier Room	80	34 - 36
Panorama Room	20	36
Ocean Club Room	60	36
Panorama Suite	15	72
Presidential Suite	1	216

## GUESTROOM FEATURES

All guestrooms are fully equipped with modern amenities including:

- Complimentary in-room wired Internet and Wi-Fi access
- Cable television
- IDD telephone with bathroom extension
- Laundry and valet service
- Mini-bar
- Voice mail
- Electronic safe
- Coffee and tea-making facilities

## BUSINESS CENTRE

The fully equipped business centre offers a wide range of secretarial support including courier, facsimile, photocopying and printing services. Private meeting rooms are also available with a host of modern audiovisual, videoconferencing and projection facilities plus complimentary broadband Internet access and Wi-Fi connection.

## CHI, THE SPA AT SHANGRI-LA

A secluded village within the resort, CHI, The Spa at Shangri-La is a luxurious escape of harmony. The spa village sprawls on 10,000 sqm of private villas, gardens, pools and baths - one of the largest of its kind in Asia. Many of the spa's massages and treatments are based on the traditional healing methods found in the Philippines and use natural plants, herbs and botanical products shared by many Asian cultures.

## RECREATION FACILITIES

- Adventure Zone is an indoor, air-conditioned playground specially designed for children aged four years and above. The multi-storey playground lets children swing on ropes, climb up and down nets and ladders or crawl through shapes and heights of safely padded vinyl. Daily children's activities are available. Long-sleeved shirts and socks are required for safety.
- The Toddler Zone is a play area for children aged three years and below. Children must be accompanied by a parent or guardian at all times.
- E-Zone is a complete entertainment hub which offers a TimeZone arcade, Xbox 360 video games, wired Internet and Wi-Fi access, a sports lounge, a snack bar and a stylish karaoke room with over 20,000 multilingual songs.
- 350-metre beach cove
- Fully-equipped health club and gym with sauna, steam bath and massage rooms
- (1) 700m<sup>2</sup> and (1) 1,500m<sup>2</sup> swimming pool and sundeck areas with separate children's pool and aquaplay area
- Parasailing, sailboats, sea kayaking and windsurfing
- Scuba diving and snorkeling
- Water sports and jet-skiing
- Speedboat fun rides
- Six-hole pitch and putt and themed mini-golf
- Tennis court
- Marine Sanctuary - six-hectare sanctuary that houses over 160 species of marine life

## RESTAURANTS AND BARS

Restaurants / Bars	Capacity	Location	Cuisine
Tides	303	Garden level	International
Tea of Spring	117	Garden level	Chinese
Cowrie Cove Seafood Bar and Grill	220	Ocean front	Seafood
Acqua	151	Garden level	Italian
Buko Bar	165	Pool side	Light fare
Lobby Lounge	145	Lobby level	Drinks and snacks
Breeze	44	Beach	Drinks and snacks

## BANQUET AND CONFERENCE ROOMS

Venue	Capacity					Dimensions (m)	Area (m <sup>2</sup> )	Ceiling Height (m)
	Reception	Theatre	Banquet	Classroom	Boardroom			
Ocean Pavilion	100	100	60	30	•	10.0 x 13.8	138	11.0
Mactan Ballroom	600	600	480	260	210	48.0 x 14.0	672	3.6
Pre-function Area	400	•	•	•	•	48.0 x 10.0	480	3.6
Mactan Ballroom I	100	100	80	48	35	8.0 x 14.0	112	3.6
Mactan Ballroom II	100	100	80	48	35	8.0 x 14.0	112	3.6
Mactan Ballroom III	200	200	160	90	55	16.0 x 14.0	224	3.6
Mactan Ballroom IV	200	200	160	90	55	16.0 x 14.0	224	3.6
Rosal Ballroom	270	240	180	108	75	24.0 x 13.5	324	3.7
Rosal Ballroom I	90	80	60	36	30	8.0 x 13.5	108	3.7
Rosal Ballroom II	90	80	60	36	30	8.0 x 13.5	108	3.7
Rosal Ballroom III	90	80	60	36	30	8.0 x 13.5	108	3.7
<b>Function Rooms</b>								
Bougainvillea	35	30	20	15	18	7.9 x 5.4	43	3.4
Camia	55	30	40	24	30	7.8 x 7.6	59	3.4
Jasmine	110	92	60	55	50	16.4 x 7.6	125	3.4
Camotes	•	•	20	9	18	11.58 x 7.97	92.3	3.3
Olango	•	•	•	•	12	11.58 x 7.97	92.3	3.3
<b>Outdoor</b>								
Chapel Garden	200	•	150	•	•	•	•	•
Golf Helipad	600	•	250	•	•	•	•	•
Ocean Terraces	300	•	200	•	•	•	•	•
Beachfront	800	•	400	•	•	•	•	•
Buko Bar Garden	200	•	150	•	•	•	•	•

MAIN WING – GARDEN LEVEL

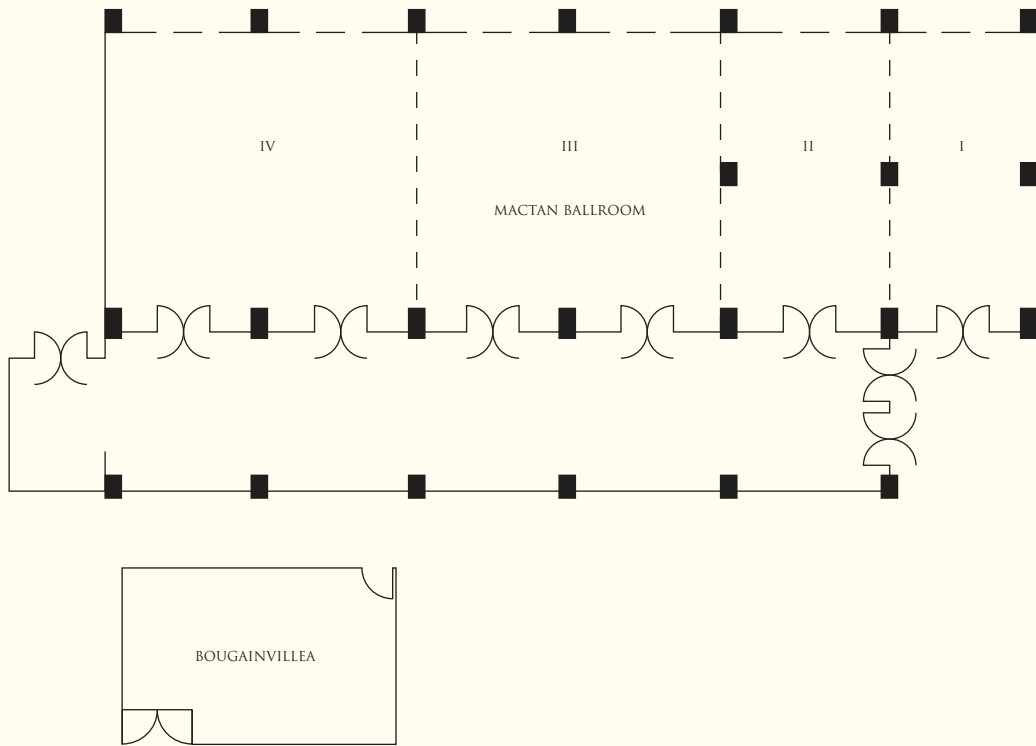

MAIN WING – LOBBY LEVEL

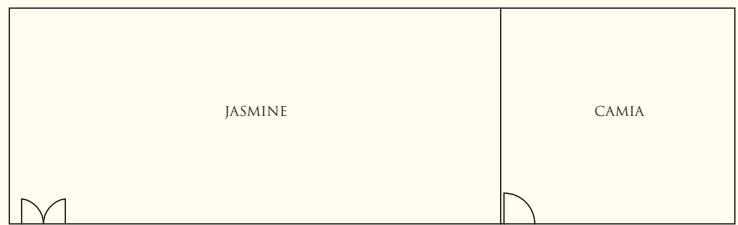

GARDEN LEVEL



GARDEN LEVEL

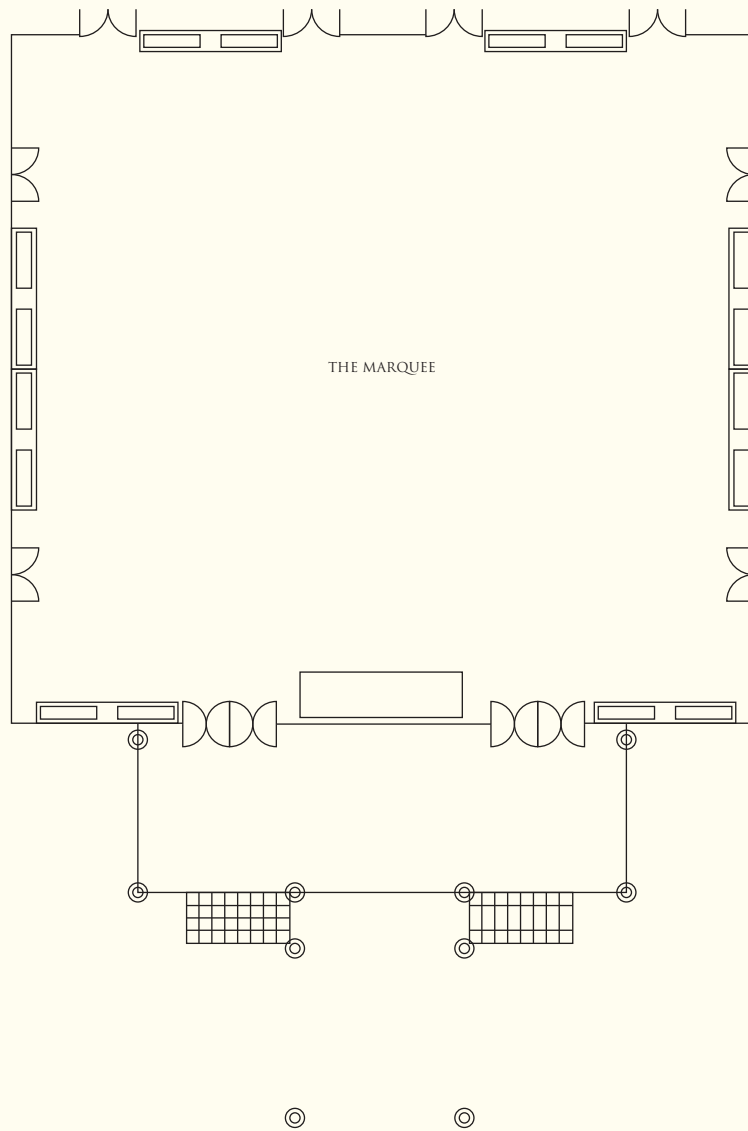

OCEAN WING – GROUND LEVEL

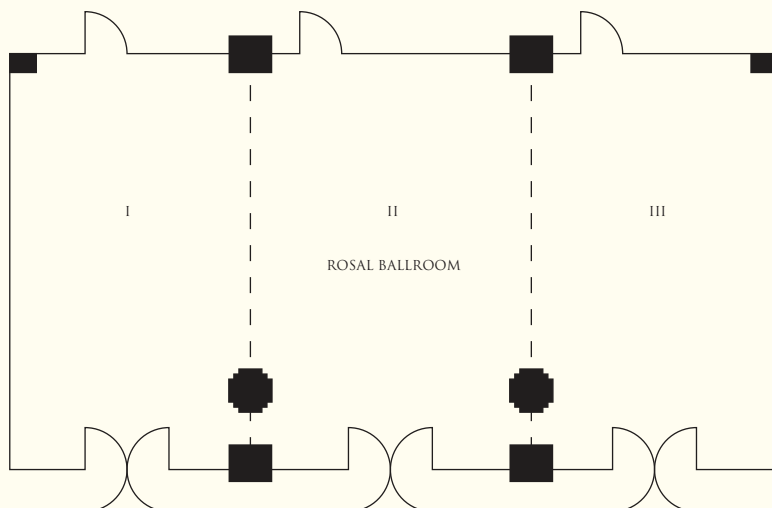



**SHANGRI-LA**

HOTELS *and* RESORTS

Shangri-La's Mactan Resort & Spa, Cebu

Punta Engaño Road, Lapu-Lapu City 6015, Cebu, Philippines

Tel: (63 32) 231 0288 Fax: (63 32) 231 1688 [mac@shangri-la.com](mailto:mac@shangri-la.com) [www.shangri-la.com](http://www.shangri-la.com)